

IT'S HAPPENING! SKATEPARK 2024!!!



2023 ANNUAL REPORT
GND DEVELOPMENT ALLIANCE



OUR MISSION

We are dedicated to providing a place to be used by members of the community for social, cultural, learning and recreational purposes.

WE VALUE

our community and each of its members

education, physical activity and our environment

those who promote positive actions and give back to our community

the opportunity to have fun as we promote services in our community and strong personal relationships

WE SERVE

children through seniors by offering a wide variety of amenities, programming, and structured and unstructured activities to enjoy.



The GND Development Alliance operates as the GND REC, located at

**801 101st Avenue West
Duluth, MN 55808**

MAKING A DIFFERENCE

We have raised enough funds to complete the capital improvements. We are out for bids to complete the skatepark, our final amenity at the GND REC and the crown jewel. The skatepark will be an urban style streetscape design that will provide a challenging opportunity for the estimated 3,500 local skateboarders—and a regional draw for many more.

Thank you to all who have supported us to this point including but not limited to: the City of Duluth, St. Louis County, foundations, the private sector, trade unions, individual contributors and our many volunteers.

"What an amazing opportunity to be a part of such a diverse and unique organization that is prepping for its final crown jewel amenity this year—the urban street skatepark. The synergy and excitement for the skatepark and vitality of the entire GND REC is absolutely astounding. It is an incredible destination. Of course, none of it would have been possible without the tremendous giving from our community members, local and nationwide businesses, charitable foundation contributions, city and county officials, and volunteers. We are extremely grateful for the support and long-term future of the GND REC. YOU are making a difference!"

—Barb Bucar, Vice President, GND Development Alliance

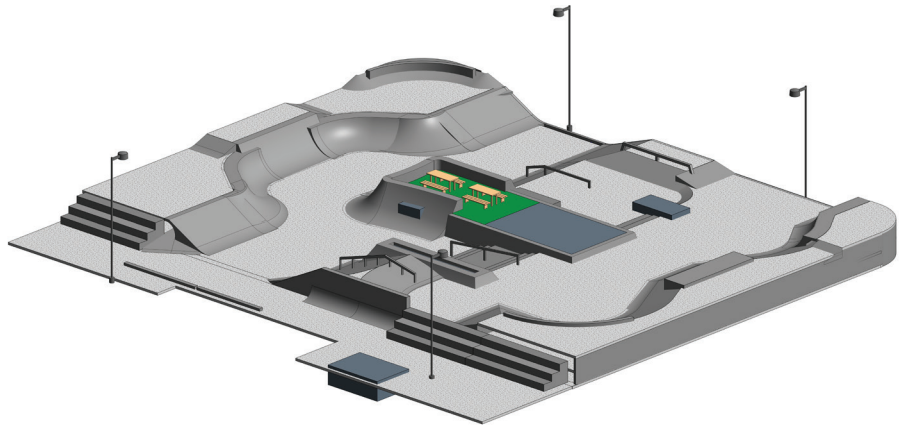

BOARD MEMBERS

Mark Boben, *Chair*

Gary Bubalo
Sr. Vice President

Barb Bucar,
Vice President

Robert Espenson,
Secretary

Kristen Haller

Dale Lewis

Wyatt Lindberg

Fran Morris

Jack Rendulich

Ryan Sather, *Treasurer*

Chris Skull

Mike Tusken

Mary White

IT'S HAPPENING! THROUGH COMMUNITY & GENEROSITY

**Our original
\$3.3 million
fundraising goal
was exceeded!**

And we couldn't be prouder—
of our community. Of our
board. Of our program providers
and our program participants.
Of our donors. Of all of us, for
what we've accomplished during
2023. We cover some of the
highlights in the pages
that follow.

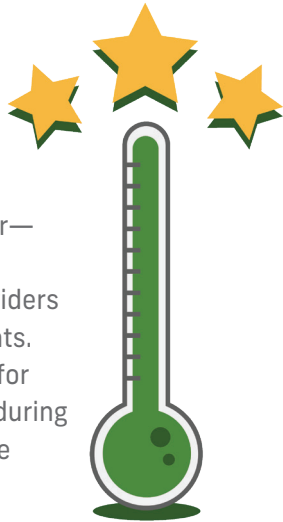

Future Needs

We're celebrating *our* accomplishments
- *your* accomplishments! - and planning
our future. Community giving provides
for ongoing operational needs including
programming and special events as well
as meeting our construction goals which
includes completing the new parking lot
and sidewalks. We estimate that additional
constructions costs could reach \$180,000
due to construction cost inflation.

*Please see page 6 for more information about
giving to meet ongoing and future needs.*

IT'S HAPPENING! IN THE GND REC COMMUNITY

Our vision of the GND REC Center as
the family center of the community
continues to grow and develop.
We've included a few of the
highlights from 2023.

Our Community's Youth

Our community partners continue to
work with our youth, contributing their
time and materials so generously.
Please see the inside back cover for
more information about our partners.

**Youth programming is FREE of
charge—every young person in our
community has access to the GND REC
programs and events!**

Youth activities during
2023 included:

- After school youth programming
- Youth field trips - Enger Tower,
Hartley Nature Center, Chambers
Grove, North Shore Scenic Railroad
- Cross country skiing
- Happily Haunted Hike
- Annual I Love to Read event
- Stowe School End of the Year Party
- Far West Kidz Fest



IT'S HAPPENING! IN THE GND REC COMMUNITY

Community Celebrations and Community Fundraising

The GND REC community celebrated with music in 2023:

- Independence Celebration Concert featuring Donny Buck
- Fish Heads in concert

The GNC REC community continued its tradition of community fundraising:

- Two rummage sales - one in the spring and one in the fall
- Holiday bake sale

Adult Programs

The GND REC community continued to enjoy adult programming:

- Exercise classes and more for active adults
- Senior lunch
- Mental health presentation
- Project Joy - free meals for youth delivered by Union Gospel Mission



The skateboard community joined us for some very valuable community input:

- *City Council advocacy with skateboarders*

FROM FITNESS TO FRIENDSHIP

In 2020 I was asked to teach some YMCA Fitness Classes at the GND REC.

I had heard rumors about the welcoming, fun and community-minded people in Gary-New Duluth. I was excited to bring a new class program, meet new people and learn about an area I didn't know much about. Little did I know I was going to have the opportunity to not only help folks stay strong and healthy, but also that these classes would help grow a tight-knit community of forever fitness friends!

Group fitness classes are about much more than just getting "in shape"—it's about the connections made, the laughter, the fun and support of one another in the good times and the bad.

Our fitness group not only gets together to exercise but they also volunteer at the GND REC, meet for walks, hikes, and other social events and activities. I am grateful and blessed to have gotten to know these people and this welcoming community at the GND REC! If it weren't for this building and all the people who support it, we wouldn't have these classes and activities that enrich so many lives! Thank you, GND REC Community!

—*Heidi Rudstrom, ForeverWell
Coordinator, Duluth Area Family YMCA*



WE'RE SO EXCITED FOR WHAT'S AHEAD

The Gary-New Duluth Community Center and Recreation area (GND REC) is the cement of a wonderful foundation for Gary-New Duluth and its surrounding areas. It offers so much for all ages and is staffed by such wonderful people, including volunteers. The GND REC is a great place to give donations when thinking about what matters in the lives of our



community and City of Duluth. It is "the place" to consider.

We would like to see the GND REC continue with all it has to offer in years to come as the cost of new focuses, maintenance, programs, etc. increases with time.

Another great idea is when you are doing your estate planning, to leave a remembrance to the GND REC. You are supporting our community and giving thanks for all the facility has done to make Gary-New Duluth—and all who benefit from the Center—their home away from home!

—*Helene "Sissy" Abbott*

The GND REC has naming rights available for the skatepark and soccer field #1 and soccer field #2. Additionally, we have established an endowment fund to ensure that we have sustainable funding into the future. Please contact us for more information.

Make a donation now by mailing your check to:

**GND Development Alliance
2630 West Superior Street
Duluth, MN 55806**

Or via the GND REC webpage:

<https://gnd.community/get-involved/donate/>

Or via Venmo: Venmo at:

@GNDSKATEPARK

Your donations are recognized on our web site and in our annual report. If you prefer to remain anonymous, your donation is listed as such.



venmo

THE BEST COMMUNITY CENTER AROUND

I'm a true Gary-New Duluth native—born and raised here. I believe I had one of the best upbringings a child and young adult could ever experience. My belief in this is in large part due to the very close-knit, caring, safe, clean, engaging, and family-oriented community I was fortunate enough to be a part of, early in life, right from my beginning.



After graduating from Denfeld High School, I committed to serving in the military, leaving my hometown and giving back to my country. After honorably serving a successful 30-year career, I retired.

I could have retired anywhere. I decided to return to my hometown and focus on ways to give back to this one-of-a-kind community that afforded me childhood experiences that proved critical to forming me into the person I am today. I wanted nothing more than to give others in my community the coveted opportunities I was given. I feel incredibly fortunate to have returned to my original roots as there is just no place like it anywhere in the country.

As a kid, I spent countless hours with my friends enjoying the GND REC, which, back then, was well known as the "Shack." I cherish the fond memories and safe and exciting experiences I gained from the Shack but honestly didn't realize, until much later in life, how lucky I was to have this in my community.

As an adult, I now recognize that it's an extraordinary group of volunteers, vision seekers, and leaders that has created the GND Development Alliance. This group has selflessly served to revitalize—and now continues to keep growing—the GND REC as the best community center around.

Thanks to this phenomenal group, I can help assist and pursue my goal of giving other kids the opportunity I was given growing up. Children and adults of all ages are getting access to the best amenities and experiences that otherwise would not be available.

I'm thrilled to join forces with the team—to continue to help provide a place that offers a plethora of opportunities for community members of Gary-New Duluth, the City of Duluth and the upper Midwest.

—*Barb Bucar, Vice President,
GND Development Alliance*

FINANCIALS

Income

(Year Ended June 30, 2023)

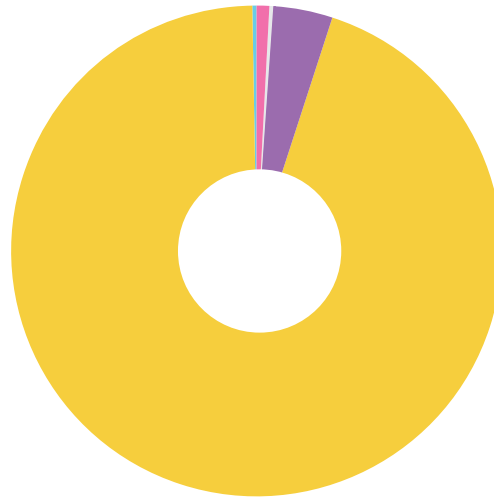

- Other \$1,297
- Facility Rental \$540
- Fundraisers \$9,780
- Public Support \$237,460
- Interest Income \$711

Expenses

(Year Ended June 30, 2023)

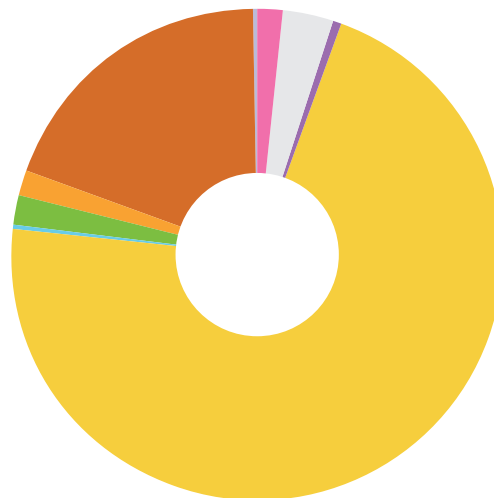

- Facilities and Equipment \$3,241
- Fundraising \$5,517
- Other Expenses \$661
- Phase 3 Improvements \$119,909
- Phase 2 Improvements \$250
- Insurance \$3,412
- Design, Architecture and Engineer Fees \$2,479
- Operations \$32,541
- Business Expenses \$100

Total Project Expenses

(Year Ended June 30, 2023)

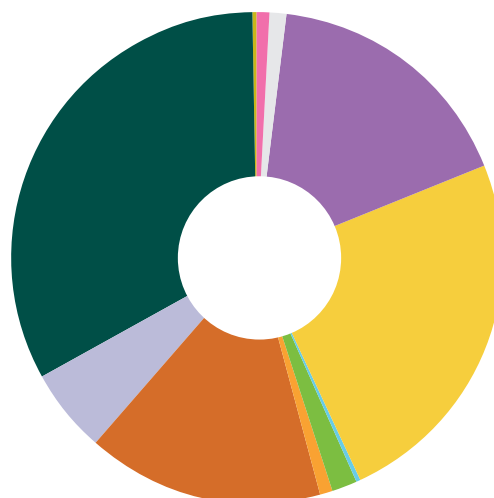

- Facilities and Equipment \$17,340
- Fundraising \$19,406
- Phase 2 Improvements \$288,764
- Phase 3 Improvements \$418,583
- Other Expenses \$4,915
- Insurance \$27,428
- Legal Fees \$12,940
- Operations \$270,580
- Design, Architecture and Engineer Fees \$95,171
- Phase 1 Improvements \$564,769
- Business Expenses \$861

2023 CONTRIBUTORS *Through December 31, 2023*

Friends

Donations Under \$100

Brady Anderson
Andres Almarza
Anonymous
In Memory of: Vincent Arezzo Sr.
Nancy Arvidson
In Memory of: Joe Balach
Carol Barnstorf

Christian Cairy
Al & Yvonne Carl
Charities Aid Foundation America
Melissa Class
In Honor of: Stephan Colich
Kermit & Marilyn Cook
Heidi Envall
Patricia Erickson
Conrad & Martha Firling
Bob & Gayle Gilmore
Regis Glumac

David Grenwis
Evanna Judkins
Josh Kosanovich
In Honor of: Mary Jo (Balach) Lund
Denette Lynch
Alyssa Mendo
Paul & Patti Modeen
Robert Paul
Mary Petrich
In Honor of: Mary Petrich
Yvonne Puhl

Kyle Roth
Elizabeth Sawyer
Helen Stojevich
In Honor of: Helen Stojevich
In Honor of: Jeanie Stojevich
In Memory of: Murial Kay Strand
James & Doris Thorsen
Bob & Jean Vanderport
Robert Verzicht
In Honor of: Mike Zigich
Wyatt Zulkosky

Blue/White Club

Donations From \$100 to \$499

Helene K. Abbott
In Memory of: Madelyne Abbott
Adolphson Real Estate
Janet Akervik
Anonymous
Mary & Dwight Barth
Kevin & Kathy Behm
Yvonne Rizzi-Belich
Tom Bell
Clark & Patty Bennett
Donna Benson
In Memory of: Mary Ann Berg
Robert Berg
Lyle & Lynn Bergal
Andrew Bernstein

David & Jill Blazevec Family
In Honor of: Linda Boben
Kelly & David Bolgrien
In Memory of: Dan Bubalo
In Honor of: Frank Bucar, Barb Bucar & Brenda Jacobs
Tracy & Kay Burger
In Memory of: Bill Damkroeger
Nancy & Alexander Darbut
Bill & Connie Dinan
Dick Dragevich
Robert & Linda Espenson
Essentia Health
Brenda Fife
Richard & Barbara Fischer
Harold & Ruth Frederick
Dan & Sue Gigliotti
In Memory of: Tom Gillen
Bill Glowacki
Walt & Kay Gower
Bill & Kisty Haller

Larry & Jeanne Ivanovich
Dale M. Johnson
Tony & Lois Kochevar
Jon & Patty Langlee
Robert & Marilyn Maas
Mars Supply
John & Patricia Miller
Sam Misceвич
Mike & Kim Monson
James & Frances Morris
Alice Nordin
Peter & Maureen Olson
Jo-Ann Pasek
Michael & Mary Pavlovich
Ted & Rae Ann Pavlovich
In Memory of: Joe Petrovich
Jim & Heath Ransom
Thomas Rendulich
Dick & Nancy Richie
John & Barbara Rodberg
In Memory of: Neale Roth

Mark & Nancy Rubin
Jack & Cindy (Macor) Seiler
Lawrence Sever Family
John & Barbara Skull
Jerry & Carol Smith
John & Judy Smolnikar
Amanda Soberg
Louie & Pat St. George
In Honor of: Polly Stojevich
Carolyn Sundquist
In Memory of: Agnes Turk
Marilyn Tygart
In Memory of: Raymond Ulvi
Kevin Walli
N. Dale Weller
West Duluth American Legion
Post No. 71
In Memory of: Anna Mae Westerlund
Young & Associates Agency Inc.

Principal's Club

Donations From \$500 to \$999

Daniel Lambi Balach
George Balach
Judge David & Gloria Bouschor
Barb Bucar
Carrie Schoen & Danyll Foix

In Memory of: Charlie & Bea Herman
Debbie Inwood
Helena Jackson
Elaine Killen
Dale Lewis

Gilbert (Pete) & Janice Nelson
Helen Rizzi
Marcella Vaydich
Steve & Nancy Waters

Community Pillars

Donations From \$1,000 to \$2,499

In Memory of: Robert Balach
Allen Boben
In Memory of: Pamela Boben
Ronald & Margaret Boben
Buffalo House / Scott Stoyanoff
Darrill & Rita Erickson
Ted & Carol Griak

Irving Community Association
Don Joe
Clyde & Julie Johnson
KSKJ Life
Bob & Diane Meierhoff
In Memory of: Joseph Meese
Joe & Ryann Signorelli

Mark & Gale Smithson
In Memory of: Ronald Soberg
In Memory of: William M. & Suintina T. Spehar
In Memory of: Helen Stojevich

Commonwealth Avenue Society

Donations From \$2,500 to \$4,999

Ted & Gretchen Bogich
Mary & Mike Ives
Darrel & Yvette Johnson

1914 Associates

Donations From \$5,000 to \$9,999

Mark & Linda Boben
Gary & Kathleen Bubalo
Violet Letica
Jeff & Jill Widness / HMI

Founders Society

Donations From \$10,000 to \$24,999

Bernick Family Foundation
Al & Erika Hodnik
Darrel D. Johnson Excavating
maurices
Cheryl & Joe Meese
Northland Foundation

Diamond

Donations From \$250,000 to \$999,999

St. Louis County

Friends

Donations under \$100

Andres Almarza
 Brady Anderson
 Anonymous
 Anonymous
In Memory of: Vincent Arezzo Sr.
 Nancy Arvidson
 Joe & Shirley Balach
 Steve & Marlene Balach
 Therese Balach
 Carol Barnstorff
 Mindi Baski
 Doug & Cheryl Belanger
 John & Alice Berg
 Donna Bergstrom
 Donna Bewley
 Joe Blum
 James & Laura Booth
 Kyle Boyat
 Jon Brostowitz
In Memory of: Burger Family
 Florence Burger
 Terry Burger
 Christian Cairy
In Memory of: Janet Elizabeth Calhoun
 Al & Yvonne Carl
 Mike Sr. & Aurine Casey
 Michael Cheetham
 Al Chepelnik
 Melissa Class

In Honor of: Stephan Colich
 Penny & Michael Cragin
 Maranda DeSanto
 Cole DiMeglio
 Sandy Dinehart
 Chuck & Cheri Duval
 Duluth Women's Club
 Brent Elling
 Heidi Enval
 Sharon & Charles Fedora
 Conrad & Martha Firling
 Anna Foster
 Dave Geary & Deanne Roquet
In Memory of: Mary Giacominni
 Bob & Gayle Gilmore
 David Grenwis
 Karen Griffith
 Jake Grondahl
 Mark & Jill Hakala
 William & Cheryl Hallamek
 Martha Han
 Richard Haney
 Tom & Marsha Hystad
 Brenda Jacobs
 Jimmy's Kitchen & Bar
 Sean Jones
 Allen Johnson
 Evanna Judkins
 Nicola Jurich
 Jackson Karren
 Janet Kennedy
 Kristen Kimsey
 Carroll Koliboski
 Jeanne C. Koneczny

Josh Kosanovich
 Geraldine Kozloski
In Memory of: Gina Kozul
 Pamela Kramer
 Timothy Larson
 Linda & Arthur Lezama
In Honor of: Mary Jo (Balach) Lund
 Denette Lynch
 Jaki Majeski
 Patricia Mazur
 Brian & Karen McCormick
 Peter & Helen McDonnell
 Kathleen McKeever
 Ann Marie Menart
 Alyssa Mendo
 Anna Montgomery
 Carole Newkumet
 North Point Realty LLC
 Sam Odden
 Jon & Gail Ohman
In Honor of: Paulette Ozzello
 Parna: Life Source Healing
 Robert Paul
 Kayla Petrich
In Memory of: Theresa Petrich
 Roberta & Wayne Prince
 Mark Privratsky
 Sherri Puckett
 Donna Puhl
 Cliff & Nancy Regan
 Joanne Regan
In Honor of: Rendulich Family
 Tom & Kim Rendulich
 Kyle Roth

Anna Rozova
In Memory of: Sheila Samarzia
In Memory of: Georgeann Sams
 John Schneider
 Melody Schneider
In Memory of: Ron Seguin
 Charles & Barbara Seipp
 Diane Skomars
 Brenda Skorich
 Slovenian Union of America
 Trevor J. Smith
 Glen & Mary Jane Sorenson
 Vera Stephenson
In Honor of: Jeanie Stojevich
In Memory of: John Stojevich
In Memory of: John Stojevich & sons;
 Tony, John Jr. & Bobby
In Memory of: Stoyanoff Family
 Mary Beth Strand
In Memory of: Murial Kay Strand
 Barbara Sulini
 John Susnik
 James & Doris Thorsen
 Terese Tomanek
 Lisa Van Doren
 John & Edna Weber
 Pat Whalen
 Mary White
 Evelyn Wietman
 Claudia Wilson
 Mandi Wojciehowski
 Cami Wolk
In Honor of: Mike Zigich
 Wyatt Zulkosky

Blue/White Club

Donations From \$100 to \$499

In Memory of: Madelyne Abbott
 Richard & Yvonne Anderson
 Andren Paint Company / Pete Olson
 Anonymous
In Memory of: Santo J. Antonutti
In Honor of: Joanie Balach
 Lana Joy Balach
 Robert Balach
 Steve Balach Jr.
In Honor of: Steve Balach Jr.
 Mary & Dwight Barth
 Tanya Beckwirth
 Kevin & Kathy Behm
 Brad Bennett
 Clark & Patt Bennett
 Douglas & Beverly Bennett
 James Bennett
In Memory of: Ron Benson
In Memory of: Mary Ann Berg
 Kathleen Bergen
 Thomas Bergum
 Andrew Bernstein
 Craig Binsfield
 David & Jill Blazevec Family
 Diane Bloomquist
In Honor of: Linda Boben
In Honor of: Mark & Linda Boben
 Pamela Boben
In Memory of: Stanley & Ruth Boben
 Kelly & David Bolgrien
 Rebecca Bosanko
 Patrice Bradley
In Memory of: Bob Brophy
 Dorothy Bubacz
In Memory of: Dorothy Bubacz
In Honor of: Frank Bucar, Barb Bucar & Brenda Jacobs

Leslie & Frank Bucar
In Memory of: Buddy
 Ken Buehler
 James Caesar
 John & Tracy Carey
 Mike Jr. & Laurie Casey
 River Place Campground
 Max Caven Photography
 Charities Aid
 Foundation America
In Honor of: Children of Our Community
 Alison Clarke
 Eugene Collard
 Lee Conradi
 Kermit & Marilyn Cook
In Memory of: Bill Damkroeger
 Cheryl Danielson
 Mark Danielson
 Nancy & Alexander Darbut
 Marlene David
 Al & Susie Decker
 Douglas Delaney
 Brenda S. Denton / Denton Law Office
 Michael & Tanya Dmowski
 Duluth Brass Manufacturing
 Ruth Ann Eaton
In Memory of: Dr. Mark Eckman
 Gary & Kathleen Eisenach
 Maxwell Elfelt
 David Emery
 Melissa Engbretson
 Patricia (Balach) Erickson
 Essentia Health
 Suzy Fairchild
 Brenda Fife
 Mike Fife
 Kelly Finnegan
In Honor of: Barbara & Dick Fischer
In Memory of: Joseph Floreano
 Fond du Lac Community Club
 John & Julie Foucault
 Tyrone & Sharon Frost
 Agnes Gallenberg

Gartner Refrigeration Company
 Elizabeth M. George & Dale D. Sola
 Charitable Trust
 Eric Gibson
 Dan & Sue Gigliotti
In Memory of: Tom Gillen
 Robert & Karen Glowacki
 Regis Glumac
 GND Cub Scouts Pack 3013
 Andrew & Molly Goldfine
 Beverly Goldfine
In Memory of: Beverly Goldfine
In Memory of: John Mestnick Grassinger
 Wilhelm & Jennifer Grau
 William & Barbara Gravelle
In Memory of: Steve (Stojan) Griak
 Lorrie (Nordberg) Griffin
 Donald Gustafson
 Edwin & Sherry Hall
 Timothy Hamman
 Carmen Hartley
 Roger Hartley
 Michael & Liz Henderson
 Charles & Beatrice Herman
In Memory of: Charlie Herman
 Bonnie Hirsch
 Joan & Justin Hoffmann
In Memory of: Richard Hoffman
 Karlie Howard / Computer World
 Technology
 Husky Energy
In Memory of: Joe Janchar
 Joe & Alice Janchar
In Memory of: Agnes Jones
 Ken & Norma Johnson
In Memory of: Larry Johnson
 Roxanne Kaldor
 Rosemary Kosevich
In Memory of: Ernie & Martha Laine
In Memory of: Jimmy Lane
In Honor of: Eileen Langlee
 Jon & Patty Langlee
 Michelle Lebeau

Steve Leticia Family
 Ann Lewis
 Brian & Sue Liberty
In Memory of: Bob Marnich
 Dan & Jeanne Marnich
 Darrell Martin
 Renee Mattson
 Kevin & Shirley McConnell
 Bill & Gay Vaughn McEwen
 David McLean
In Memory of: Mark Medved
In Memory of: Sharon Medved
 James Menart
 Patty Mester
 Lizette Miller
In Memory of: Patricia M. Modeen
 Paul & Patt Modeen
 Kim & Mike Monson
In Honor of: Jim Morris
 Scott Morris
In Memory of: Frank & Betty Mrak
 Nassin Family
 Florence Nasti
 Chris & Judy Nelson
 Gilbert (Pete) & Janice Nelson
 Richard Nordberg
 Robert Nordberg
 Alice Nordin
 Millicent O'Connell
 Beth Olson
 Peter & Maureen Olson
 Thomas & Carol Ornell
 Jo-Ann Pasek
 Marilynn Pavlich
 Michael & Mary Pavlovich
 Kelly Pelto
In Honor of: Mary Petrich
In Memory of: Thanie Petrich
 Jerry Pfeffer
 Denny & Pat Picconatto
 Weegie Poston
 Amy Rahja
 Joy Rasmussen

Blue/White Club (cont.)

Donations From \$100 to \$499

Jack Rendulich
Thomas Rendulich
In Honor of: Helen Rizzi
In Memory of: Ray D. Rizzi
Henry & Terry Roberts
John & Barbara Rodberg
Michael Rosa
In Memory of: Neale Roth
In Memory of: Sophia & Anton Rubin (Rubcic)
In Memory of: Ray Rybos Sr.

In Memory of: Ray Rybos Sr. & Ray Rybos Jr.
Susan & Raymond Rybos
Terry Sanders
Ryan & Jackie Sather
Elizabeth Sawyer
Terri Seiler
Shamrock Trucking LLC
Cliff & Barb Sherer
Joe Siglar
Mark & Sandra Signorelli
Jerry & Carol Smith
Terri Smith
In Memory of: Vince Spallaci
Amanda Soberg
Donald Solwold

Spirit Lake Development / Charlie Stauduhar
In Memory of: Nick Srdar (Nadine Srdar)
St. George Orthodox Church
John & Jeanie Stark
Peter & Darlene Staudohar
Mark & Patti Stenhammer
David Stojevich
Helen Stojevich
In Honor of: Helen Stojevich
John & Pauline Stojevich
Patricia Stojevich
In Honor of: Polly Stojevich
Carolyn Sundquist
Janice Swanson
In Memory of: Agnes Turk
Deb Dwyer / Tutoring Duluth

Marilyn Tygart
Lori Ulvi
Raymond & Sonja Ulvi
Bob & Jean Vanderport
Steven & Vicki Veit
Robert Verzich
Kevin Walli
Lawrence Wietman Jr.
Western Area Business & Civic Club
In Memory of: Anna Mae Weterlund
Whole Foods CO-OP
Lawrence Wietman Jr.
Jim Filby Williams
Young & Associates Agency Inc.
Geigerj L. Yount
Sam & Beverly Zikovich
Elliot Zunich

Principal's Club

Donations From \$500 to \$999

Les & Rosie Adolphson
Adolphson Real Estate
Anonymous
Anonymous
David Arvold
Joanie Balach
Yvonne Rizzi-Belich
Tom Bell
Donna Benson
Robert Berg
Lyle & Lynn Bergal
Robert & Faith Bubalo
Laura Budd
Jerry & Beverly Cran

Darlyn J. Davis
In Memory of: Renee Doble
Dougherty Funeral Home
Dick Dragovich
Dolores (Dolly) Dutmer
Carrie Schoen & Danyll Foix
Greg & Sheila Fox
Richard F. Gillen
Bill Glowacki
Joyce Goldberg
Walt & Kay Gower
In Memory of: Hugo & Pearl Hansen Family
Michele & Robert Howard
Larry & Jeanne Ivanovich
Dale M. Johnson
Dale & Paul Johnson's Iron Mug
Coffee & Ale House
Peter & Tracey Kolar
Kraus-Anderson

Construction Company
John Lawien
Joe & Holly Macor
Marine Iron & Ship Building Company
Gordon R. Marinkovich
Larry & Maureen McGough
Frank & Deb Messina
John & Patricia Miller
Morgan Park Community Club
Gilbert (Pete) & Janice E. Nelson
Northern Orthotic & Prosthetic Center
Ted & Rae Ann Pavlovich
In Memory of: Rachele Peterson
Mary Petrich
Puglisi Gun Emporium
Yvonne Puhl
Jim & Heath Ransom
Dick & Nancy Richie
Riverfront Community Fund

Rotary Club – Harbortown
In Honor of: Neale & Pam Roth
Mark & Nancy Rubin
In Memory of: Bruno Seppi
Lawrence Sever Family
Shotz Bar / Kathleen Rose
In Memory of: Susan Skull
South Pier Inn
Louie & Pat St. George
St. Louis County Historical Society
Richard Turchi
Karen Turnboom
Mike & Kathy Tusken
In Memory of: Raymond Ulvi
Marcella Vaydich
Theodore & Beverly Wenum
Western Bank

Community Pillars

Donations From \$1,000 to \$2,499

Helene K. Abbott
Janet Akervik
Nick Alworth
Anonymous
Arrowhead Regional Arts Council
George Balach
In Memory of: Robert Balach
Bell Bank
Deanna Bennett Real Estate Team
Allen Boben
In Memory of: Edward & Helen Boben
In Memory of: John & Frances Boben
In Memory of: Pamela Boben
In Memory of: Norman Bourestom
Judge David & Gloria Bouschor
Mary Ann Boyat
In Memory of: Robert Boyat

In Memory of: Dan Bubalo
Barb Bucar
Frank & Sharon Bucar
Tracy & Kay Burger
In Memory of: Peter Ceskic
Susan Coen / State Farm Agency
DAMAGE Boardshop
Gloria Desmedt
Bill & Connie Dinan
Darrill & Rita Erickson
Robert & Linda Espenson
Richard & Barbara Fischer
Gary New Duluth Community Club
Bill & Lynn Gliotti
Dave Goldberg Family
Dave Goldberg / Vintage Acres
Manufactured Home Community
In Memory of: Charlie Herman
Debbie Inwood
Helena Jackson
Tony & Lois Kochevar
Korner Store
KSKJ Life

A.W. Kuettel & Sons, Inc.
Marty Larsen
Robert E. & Jacquelyn Larsen
In Memory of: Leticia Family
Robert W. & Mary Jo (Balach) Lund
Robert & Marilyn Maas
Mars Supply
In Memory of: Joseph Meese
Bob & Diane Meierhoff
Sam Miscevic
Mont du Lac Resort
James & Fran Morris
In Memory of: James Morris
In Memory of: Richard & Claire Nordberg
North Shore Bank
Mary Olin
In Memory of: Bertha Panyan
Park State Bank
Police Service Dogs
Real Living Messina & Associates
Neale & Pam Roth
St. Luke's Hospital

In Memory of: Kenneth Schoen
Jack & Cynthia (Macor) Seiler
Joe & Ryann Signorelli
Mitchell & Elva Sill
John & Barbara Skull
John & Judy Smolnikar
In Memory of: Ronald J. Soberg
In Memory of: William M. & Suintina T. Spehar
In Memory of: David Stoyevich
Dale & Stefani Summerlin
Roland Thomas
Kenneth & Jeanette Turnboom
Dr. Scott & Dana Varland
In Memory of: John Vekich
Walmart
Steve & Nancy Waters
N. Dale Weller
West Duluth American Legion
Post N. 71

Commonwealth Avenue Society

Donations From \$2,500 to \$4,999

John T. & Elizabeth T. Adams
Art Fund of the Duluth Superior Area Community Foundation
Daniel Lambi Balach
In Memory of: Joe Balach
In Memory of: Steve Balach
Buffalo House / Scott Stoyanoff
Duluth Dog Parks
Darril & Rita Erickson

Dick Forbort Trojan Legacy
Ann Glumac & Bill Ulland
IKONICS Corporation
Irving Community Association
Mary & Mike Ives
Don Joe
Clyde & Julie Johnson
In Memory of: Jack E. Johnson
Steve & Marcia Johnson

Elaine Killen
Lahti Foundation
Lake Superior Area REALTOR®, Inc.
In Memory of: Joe Petrovich
John & Linda Puglisi
Helen Rizzi
Mark & Gale Smithson
In Memory of: Joe & Helen Stojevich

1914 Associates

Donations From \$5,000 to \$9,999

Ronald & Margaret Boben
Ted Bogich
BRETMIN Charitable Foundation
Debra Cervenka
Essentia Health Community Giving
Harold & Ruth Frederick

Ted & Carol Griak
Bill & Kisty Haller
The JAMAR Company
Darrel & Yvette Johnson
Violet Leticia
Dale Lewis

Prove Collective
RBC Wealth Management
Rotary Club 25 of Duluth
Kenneth & Concetta Schoen
U.S. Bank Foundation
Wells Fargo Foundation

LIFETIME CONTRIBUTIONS *Continued Through December 31, 2023*

Founders Society

Donations From
\$10,000 to \$24,999

Anonymous
Anonymous
Bernick Family Foundation
Duluth Legacy Endowment Fund, an
affiliate of the Duluth Superior
Area Community Foundation

Enbridge Energy
George & Elizabeth Goldfarb
Family Foundation
Al & Erika Hodnik
Lakehead Constructors Inc.
maurices

Kenneth Schoen
St. Louis County Attorney's Office
John Vekich
Vonco V Duluth LLC
Jeff & Jill Widness

Harriet Beecher Stowe Society

Donations From
\$25,000 to \$49,999

Arrowhead Youth Soccer Association
Mark & Linda Boben
Gary & Kathleen Bubalo
Community Parks & Recreation Grant
ConocoPhillips

ME Elecmetal
Darrel D. Johnson Excavating
Cheryl & Joe Meese
Minnesota Power Foundation
Ordean Foundation

Silver

Donations From
\$50,000 to \$99,999

Northland Foundation
U.S. Bank Foundation /
Minnesota Vikings

Gold

Donations From
\$100,000 to \$249,999

CN
DNR STAR Grant & Coastal Grant
Lloyd K. Johnson Foundation
Vintage Acres Manufactured
Home Community

Diamond

Donations From
\$250,000 to \$999,999

City of Duluth
St. Louis County

Producing an annual list of contributors is always a challenging task with the potential for both human and computer error.

The GND Development Alliance has made every effort to list our contributors accurately. If there is an error in your listing, please accept our apologies and email us at: gnddevelopmentalliance@gmail.com so that we may correct our records.

Thank you.

Additional Grants



St. Louis County \$250,000



Bernick Family Foundation \$15,000

MANY THANKS

*The continued support of our community and community partners allows us to provide **enriching, empowering, and impactful** programming to our area youth.*

Our community partners provided major support to GND REC in 2023. These pictures celebrate that support.



KSKJ \$1,000



\$20,000



A GRANDMA'S MARATHON PROGRAM

\$3,000



Irving Community Association

"Putting for Children"

\$2,000

THANK YOU

*to those who provided in-kind contributions of labor, services and materials
and those businesses, foundations and organizations that provided significant monetary contributions.*

Advantage Systems Group
Alta Surveying
Ames Construction
Anderns Paint
Arrowhead Youth
Soccer Association
ASDCO
Bell Bank
Bernick's Beverages & Vending
Boldt Construction
BRETMIN Charitable Foundation
Brock White
Construction Materials
Carpenter's Training Institute
Century Fence
City of Duluth
Clyde Iron
CN (Canadian National Railroad)
DADS Electronics
DAMAGE Boardshop
Darrel D. Johnson Excavating
Delzotto Products
Dinehery Fence & Ironworks
Duluth Dog Park Organization

Duluth Fire House #10
Duluth Public Schools
Duluth Ready Mix
Enbridge
Kim Eskola
E-Con Placer
Essentia Health
Gary Builders Supply
Bill Glowacki
Goodin Plumbing
Granite Works
Great Lakes Stone
Greenscape Services
Hailey Sault Marketing
Hallet Dock
Halvor Trucking
Hanco Utilities
Hartel's Disposal
HMI
Ikonics
International Brotherhood of
Electrical Workers
International Union of Painters
and Allied Trades

Ironworkers 512
ISD 709 - Surplus Materials
Jake's Companies
JAMAR
J&B Trucking
Jeff Foster Trucking
Johnson Carpet One
Johnson, Killen & Seiler Attorneys
Johnson Mertz Appliances
Johnston Masonry
Kia of Duluth
Kivi Bros. Trucking
Krause Anderson Construction
A. W. Kuettel & Sons
Lakehead Constructors
Lakehead Trucking
Lake Superior Helicopter
Lake Superior Railroad Museum
Lloyd K. Johnson Foundation
London Road Rental
Mars Company
maurices
ME Global, Inc.
Midwest Excavating & Transport

Miller Creek Lawn and Landscape
Miller's Crew - John Miller,
Eric Gibson, John Gjelhaug,
Joe Kirkeby, Jim Leland,
Gary Platteter, Chris Nelson,
Ken Nynas, Chuck Seipp,
Miles Sternberg, John Vekich
MJ Iron Works
MN Department of
Natural Resources
Monarch Paving Company
Northland Constructors
North Shore Bank
Omar's Sand & Gravel
The Ordean Foundation
Out There Advertising
Park State Bank
Peat Inc.
Real Living / Messina & Associates
Jack Rendulich Photography
Rick's Tree & Stump Removal
Rotary Club
SAS + Associates
T. J. Smith

St. Louis County
St. Luke's Hospital
Sonju Two Harbors
Stewart-Taylor Printing
Sunbelt Rental
Super One
SWIM Creative
Thompson Exteriors
Ulland Brothers
United Brotherhood of Carpenters
and Joiners of America
United Rentals
US Bank Foundation
Kevin Vegar Construction
Veit & Company
Minnesota Vikings
Vintage Acres
Vista Fleet
VONCO
Wagner Zaun Architecture
Walmart
Walsh Building Products
Water Heaters Only
Wizard Works



GND Development Alliance
2630 W. Superior St.
Duluth, MN 55806

Website: gnd.community • Facebook Site: facebook.com/gnd