



GND  
DEVELOPMENT  
ALLIANCE

# the Family center

of the community

2022  
ANNUAL  
REPORT





## Our mission

We are dedicated to providing a place to be used by members of the community for social, cultural, learning and recreational purposes.

## We value

our community and each of its members

education, physical activity and our environment

those who promote positive actions and give back to our community

the opportunity to have fun as we promote services in our community and strong personal relationships

## We serve

children through seniors by offering a wide variety of amenities, programming, and structured and unstructured activities to enjoy.



The GND Development Alliance operates as the GND REC, located at

801 101st Avenue West  
Duluth, MN 55808



## We thank everyone

who has donated, contributed their talents and time, and those who have participated in the activities and opportunities we've been able to offer.

**"The GND REC is a unique and extraordinary project positively impacting our youth, driven by an extremely passionate and committed board. This multi-purpose project, so much more than a park, is community centered around family; bringing life, education and joy to the far west side of Duluth and beyond. This is one of Liz and my top projects to get behind philanthropically, they are so close!"**

—George Goldfarb, Board Director/Advisor,  
Retired Chairman President & CEO  
maurices



Liz and George Goldfarb

*Help Us Finish the  
Skatepark*

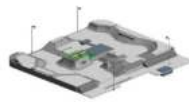

**Brews and Boards**

Lake Superior Railroad Museum  
9 June 2022



<https://gnd.community/> <https://www.facebook.com/gndcommunity>

**"What an amazing opportunity to be a part of such a diverse and unique community supporting the GND REC with a first-of-its-kind stellar fundraising event, "Brews and Boards," held at the Lake Superior Railroad Museum. From local skaters and artists, to business and community leaders, to junior and senior members of the community, a fantastic time was had by all celebrating the collaboration of raising funds for the future urban skatepark attraction being constructed in Gary-New Duluth. The synergy and excitement for the skatepark and vitality of the entire GND REC is absolutely astounding. It is an incredible**

**destination for individuals of all ages not only from the city of Duluth but the entire northern region and beyond."**

—Barb Bucar, Vice President, GND Development Alliance

# Community generosity

\$2,835,889 Funds raised as of December 31, 2022

**This is an increase of \$262,034 over last year's total.**

THANK YOU FOR BRINGING US CLOSER TO OUR GOAL.

## NEED

**We estimate that we need \$300,000 to complete construction at the GND REC.**

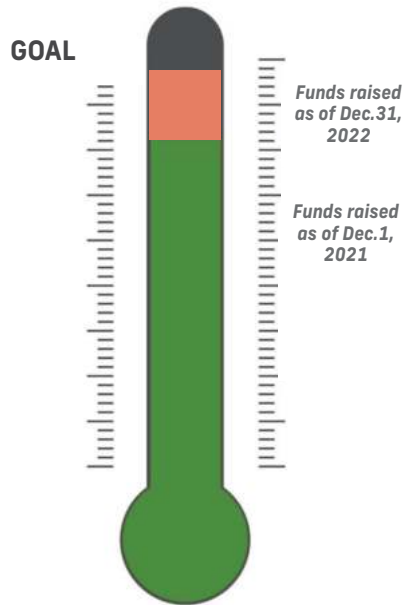

# Community progress

GND REC identifies goals each year, to work toward achieving our vision of serving as the family center of the community. Examples of those goals for 2022 included:

We conducted a major fundraising event at the Lake Superior Railroad Museum, "Brews and Boards," which not only raised a significant amount of money but had a great turnout of a very diverse group of people—young and old, skateboarders to business people, people looking for a fun night out in a fabulous venue.

We secured more than 1,000 cubic yards of sand and crushed rock for the skatepark base.

We're working to ensure our future leadership, and are focusing on bringing our next generation of leaders onto our Board of Directors.



**The GND REC Center is a community hub where neighbors of all ages find support, connections, and a safe place to be their best self.**

# Community partners

From day one we have had the vision of the GND REC being **the family center of the community**—to create a robust program for youth that encourages healthy living and allows them to grow, learn, and thrive.

## The Kids' Family Center

The GND REC is so thankful for community partners who continue to work with our youth. Here's a sampling of 2022 activities for our neighborhood youth, both indoors and outdoors, made possible by partners who have contributed their time and materials so generously. Please see inside back cover (page 15) for more information about our partners.

- GND REC, the YMCA, and Stowe School continued to partner to provide educational, emotional, and social opportunities for area youth.
  - This year's **I Love to Read** event was a success, thanks to many volunteers and contributors—including several boxes of new books donated by Barnes and Noble. Youth enjoyed free books, snacks, stories, and the opportunity to ask questions of Duluth Police Department officers. Other local leaders who participated included Mayor Larson, Superintendent John Magas, and Duluth Police Department Chief Tusken.
  - After-school snacks, healthy food choices and physical activities were provided through the YMCA's Coordinated Approach to Child Health program.
- Youth explored many topics and activities under the leadership of environmental educator Leslie Bucar.



- **watersheds, pickleball, animal defenses, moose, extinction, food waste, automata/robots, viruses and bacteria, ice fishing, floor hockey, animal adaptations, cross country skiing, camouflage, trees, creepy creatures, archery, landforms, benthic macroinvertebrates, disc golf, solar energy, mushrooms, penguins and much more**

- **Hartley Nature Center** staff worked with youth to explore the Western Lake Superior Watershed on a trip to Hartley Nature Center. GND REC youth also enjoyed field trips to **The Lake Superior Marine Museum** and **Jay Cooke State Park**.

- **The Minnesota DNR** provided saplings for youth to plant in the spring. Along with the DNR, our youth and community planted over 250 trees in May.

- **University of MN-Duluth's** outdoor education program came to the GND REC and offered classes to our youth on topics ranging from teamwork to outdoor games.



- **Duluth Parks and Rec Division** taught pickleball classes, and teamed up with Ski Hut to teach cross-country skiing.
- GND REC youth and youth from around the region participated in the first annual **Will Starks 3x3 Tournament**.
- Working with the **Duluth Community Garden Program**, GND REC youth planted and maintained three garden beds in the CN Community Garden at the GND Rec and the produce was given to food distribution efforts at the REC to help those neighbors in need.
- GND REC youth hosted the second annual "Happily Haunted Hike" for Gary-New Duluth families and youth, and youth-made luminaries lit the way to containers of candy donated by Stowe School, the GND Development Alliance, the GND Community Club, and the Duluth YMCA.

- **The Western Lake Superior Sanitary District's** Environmental Program Coordinator spoke to our youth about microorganisms and the watershed.

- Youth learned about water quality and life in the ponds near Stowe, using kits from **Great Lakes Aquarium**.





## The Adults' Family Center

Kids weren't the only ones having great experiences at the GND REC. Adult activities included:

- Adult exercise classes and yoga
- CPR & AED training with the Red Cross and St. Scholastica nursing students
- Rummage sales
- Holiday bake sale
- Concerts – **The Fish Heads, The Big Time Jazz Orchestra, DSSO Brass Ensemble**



## The Community's Family Center

Our vision of the GND REC as the family center of the community also has to have—of course—a robust community component. It's our privilege to be a part of the Gary-New Duluth community by providing space for events and activities such as:

- Informational meetings
- The Gary-New Duluth Community Club meetings
- Memorial Day ceremony
- Independence celebration and concert with the DSSO Brass Ensemble
- Community garden raised beds
- Multi-activity Sport Court to play basketball, pickle ball and 4-square hop scotch for children
- Community Action Duluth's mobile market
- The polling location for the community
- Voting and informational meetings about redistricting and voting changes affecting the Gary-New Duluth community, presented by the Gary-New Duluth Community Club
- Far West Kidz Fest & Car Show organized by the Gary-New Duluth Community Club
- Rentals of GND REC facilities for neighborhood and family events



**"The annual I Love to Read event at the GND REC is a wonderful event for Stowe students.** GND Development Alliance has worked tirelessly to provide many opportunities for the community and has developed fun and functional facilities for everyone to enjoy. The programs that are offered to children and adults alike are too numerous to list. Thank you to GND Development Alliance Board for all of your hard work to make life better for our community."

—Barb Rodberg

# Community support

The continued support of our community and community partners allows us to provide enriching, empowering, and impactful programming to our area youth. Community support during 2022 included:

- Two rummage sales—spring and fall
- Holiday bake sale
- Brews and Boards fundraiser
- Bury the Board fundraiser at Bent Paddle



## YOU CAN HELP

Please consider donating for the first time or again as we focus on finishing the skatepark in 2023.

★ **GND Skatepark Venmo Bar Code**  
 Make a donation to the skatepark using this code!

  
**venmo**

## maurices Donation

Maurices donated \$50,000 to the GND REC and the sport court is now named the "maurices sport court."



*"We are so honored to support the GND REC and truly inspired by the work they are doing.* At maurices, we are focused on community and the Gary-New Duluth REC Center is a catalyst for bringing community together, benefiting all ages and generations and creating a sense of pride in these amazing neighborhoods that have such a rich history. With our home office in Duluth, Minnesota and so many of our associates settling in to different parts of Duluth, this type of work is pivotal as we keep more Duluthians in the area and attract more people to this incredible region."

—Sue Ross, SVP, Chief HR & Communications Officer, maurices

## Additional Grants

St. Louis County .....	\$250,000
maurices.....	\$50,000
City of Duluth Tourism Tax .....	\$40,000
Lakehead Constructors, Inc. ....	\$15,000
ME Global .....	\$2,500
St. Louis County Attorney's Office .....	\$2,500
Bell Bank.....	\$1,000
Irving Community Club .....	\$1,000
North Shore Bank .....	\$1,000

**Ordean Foundation** grant to support the YMCA's Coordinated Approach to Childhood Health (CATCH) programming that encourages healthy eating and exercise

# Financials

## Income

(Year Ended June 30, 2022)

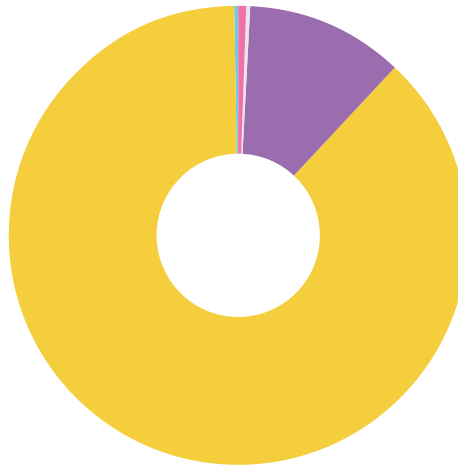

- Other  
\$1,861
- Facility Rental  
\$180
- Fundraisers  
\$26,114
- Public Support  
\$206,225
- Interest Income  
\$64

## Expenses

(Year Ended June 30, 2022)

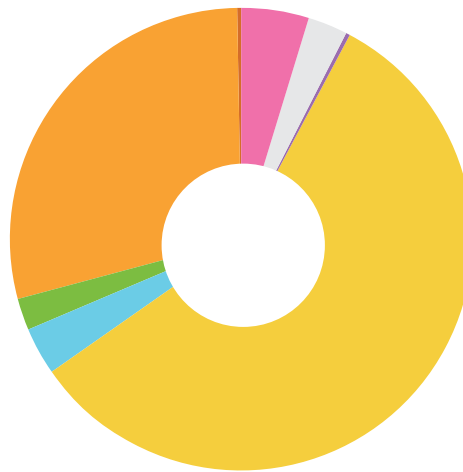

- Facilities and Equipment  
\$4,554
- Fundraising  
\$2,752
- Other Expenses  
\$106
- Phase 3 Improvements  
\$54,730
- Insurance  
\$3,188
- Design, Architecture and Engineer Fees  
\$2,000
- Operations  
\$27,347
- Business Expenses  
\$237

## Total Project Expenses

(Year Ended June 30, 2022)

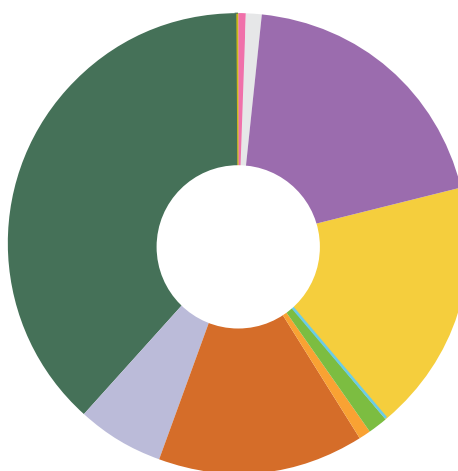

- Facilities and Equipment  
\$11,886
- Fundraising  
\$13,768
- Phase 2 Improvements  
\$288,514
- Phase 3 Improvements  
\$263,624
- Other Expenses  
\$607
- Insurance  
\$19,857
- Legal Fees  
\$12,940
- Operations  
\$214,495
- Design, Architecture and Engineer Fees  
\$91,942
- Phase 1 Improvements  
\$564,769
- Business Expenses  
\$1,463



## Where community happens

When I was a kid growing up in Morgan Park, I spent countless hours in recreational centers in Morgan Park and at the Gary-New Duluth "Shack." These facilities were not just buildings, they were the centers of the communities where my friends and I would go, to seek year-round recreation, find each other, play organized and pick-up sports from baseball, basketball, and hockey to ping-pong, pool, or a game of kickball. What we didn't know then was we were growing in many ways in our hearts and minds.



**Mike Tusken**, GND Development Alliance Board Member

We were learning to socialize with our peers, taking in life lessons from our elders and coaches, and building life-long friendships. These places provided a safe place where we all belonged. I have so many fond memories of my experiences in these places, that I cannot imagine my childhood without them.

Over the years, we watched these treasured places that served as the heart and soul of our neighborhoods, have programming and recreational opportunities diminish—and the heartbeat of our neighborhoods once hearty and strong became tired, weak, and still. A generation of people in our communities didn't have the same experiences I cherished growing up.

Under the leadership of GND Development Alliance board, a bold vision was developed using the synergy of the great people and businesses in our community and beyond to reinvest in the GND REC so it would once again be the place and space that had something for everyone...a place where community happens. The plan was an ambitious one and the community excitement was commensurate to the vision. Over the past 9 years, there has been \$3,000,000 raised in cash and in-kind donations to make a once lofty, multi-staged vision be in the final stages of becoming a reality. The "Shack" has been transformed into a fully functioning community center, new soccer fields, dog park, open air pavilion, multiactivity sport court along with parking, sidewalks, lighting and more. We are in the final stages of completion of a premier, state of the art, skatepark which will continue to provide countless opportunities for building community at the GND REC.

As a retired police officer and police chief with 30 years of service to the City of Duluth, I know all too well how important it is for our community members to belong, and have spaces and places like GND REC. A place when people talk about it, they say, "at MY community center or at OUR community center" because it is no longer a building or facility belonging to someone else, it belongs to them. These spaces invite ownership because of the experiences neighbors have together and where a stranger becomes a friend. When we have spaces and places to gather, learn, hear, and grow, we all do better. Standing on each other's shoulders, we can always reach higher together than we ever could alone. Come see us and see the smiles, see the joy, revel in the camaraderie, hear the stories, understand the struggles and the pride of overcoming it, and you will see this is more than a recreation center: the GND REC is restoring the heartbeat of our community!

## Giving back **SWIM**

"Swim donates a significant amount of time to area nonprofit organizations each year, especially to those which serve our youth. The Gary-New Duluth Recreation Center is such a positive place for kids and will be an amazing venue for activity, play and learning once all phases are complete. What a community asset! Swim's entire team cared a great deal about this project—which will continue to serve as a fundraising tool as well as a place to host progress, events and activities. Thank you to all of the people behind the scenes who have worked so hard to make this project come to life!"

—Patrice Bradley, Swim Creative



"I'm very proud that this agency has a nearly 50-year legacy of contributing back to our community. Everyone who has ever

## HAILEY SAULT



worked here has put in countless extra hours to help ensure critical nonprofits, organizations in need, and the people they both serve, can thrive. Our sense of place, whether it's Gary-New Duluth, Canal Park or elsewhere in our community is essential to who we are."

—Mike Seyfer, Hailey Sault



# Master Plan

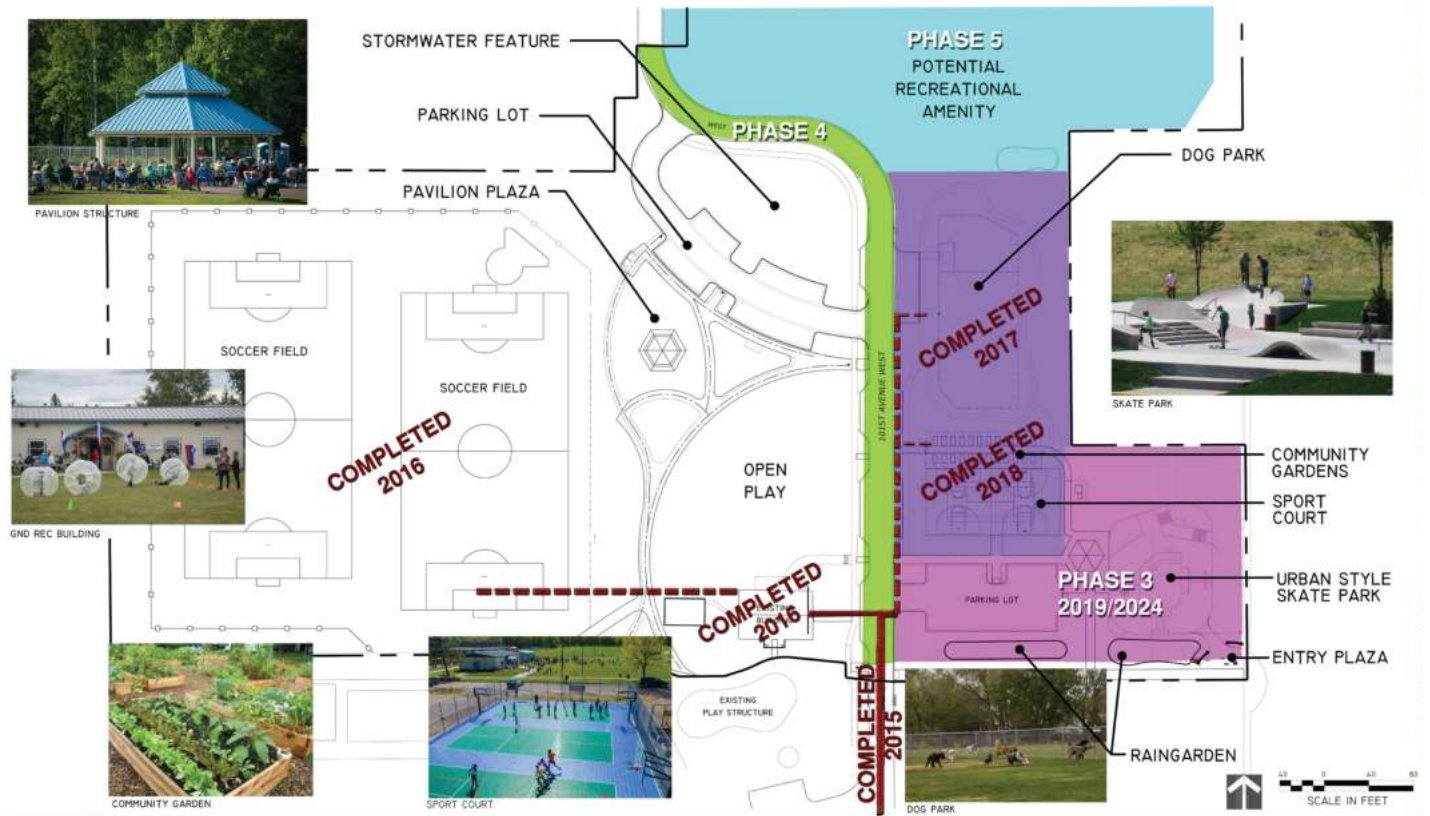

## GARY NEW DULUTH COMMUNITY CENTER AND RECREATION AREA CONCEPTUAL MASTER PLAN

**SAS**

**+ ASSOCIATES**

LANDSCAPE ARCHITECTURE

SITE DESIGN

MASTER PLANNING

URBAN DESIGN

219 WEST FIRST STREET, SUITE 350 • DULUTH • MN • 55802 • (P) 218.391.1335 • (F) 218.722.6697 • WWW.SASLANDARCH.COM



# 2022 Contributors

## Friends

*Donations Under \$100*

Joe Blum  
Al Chepelnik  
Kermit & Marilyn Cook  
*In Memory of:* Mary Giacominni  
Regis Glumac  
Edwin & Sherry Hall  
Jackson Karren

Geraldine Kozloski  
Paul & Patricia Modeen  
Jo-Ann Pasek  
Robert Paul  
Henry & Terry Roberts  
Lori Ulvi  
Evelyn Wietman

## Blue/White Club

*Donations From \$100 to \$499*

Helene K. Abbott  
Jane Akervik  
Anonymous  
Joanie Balach  
Mary & Dwight Barth  
Kevin & Kathy Behm  
Yvonne Rizzi-Belich  
Tom Bell  
Clark & Patty Bennett  
Donna Benson  
Robert Berg  
Lyle & Lynn Bergal  
Kathleen Bergen  
*In Memory of:* Edward & Helen Boben  
*In Memory of:* John & Frances Boben  
Pamela Boben  
*In Memory of:* Robert Boyat  
Tracy & Kay Burger  
*In Memory of:* Peter Ceskic  
Eugene Collard

Bill & Connie Dinan  
Suzy Fairchild  
Richard & Barbara Fischer  
Harold & Ruth Frederick  
Gary-New Duluth Community Club  
Bill & Lynn Gigliotti  
*In Memory of:* Tom Gillen  
Robert & Karen Glowacki  
Walt & Kay Gower  
Lorrie Griffin  
Bill & Kisty Haller  
*In Memory of:* Richard Hoffman  
Debbie Inwood  
Larry & Jeanne Ivanovich  
Dale M. Johnson  
Ken & Norma Johnson  
A.W. Kuettel & Sons, Inc.  
*In Honor of:* Eileen Langlee  
Bill & Gay Vaughn McEwen  
Sam Miscevech  
Kim & Mike Monson  
James & Frances Morris  
*In Honor of:* Jim Morris  
Scott Morris

Michael & Mary Pavlovich  
*In Memory of:* Rachele Peterson  
Mary Petrich  
Yvonne Puhl  
Amy Rahja  
Dick & Nancy Richie  
Helen Rizzi  
Mark & Nancy Rubin  
Lawrence Sever Family  
John & Barbara Skull  
Jerry & Carol Smith  
John & Judy Smolnikar  
Amanda Soberg  
Louie & Pat St. George  
Helen Stojevich  
*In Memory of:* Joe Stojevich  
Kevin Walli  
N. Dale Weller  
Theodore & Beverly Wenum  
West Duluth American Legion Post No. 71  
Jim Filby Williams  
Whole Foods CO-OP  
Young & Associates Agency Inc.  
Sam & Beverly Zikovich

## Principal's Club

*Donations From \$500 to \$999*

*In Memory of:* Pamela Boben  
Frank & Sharon Bucar  
Dick Dragovich  
Ted & Carol Griak  
*In Memory of:* Charlie & Bea Herman  
Michele & Robert Howard  
Helena Jackson

Don Joe  
Tony & Lois Kochevar  
Marine Iron & Ship Building Company  
Jack & Cindy (Macor) Seiler  
Mark & Gale Smithson  
*In Memory of:* David Stojevich  
Mike & Kathy Tusken

## Community Pillars

*Donations From \$1,000 to \$2,499*

Bell Bank  
Ronald & Margaret Boben  
*In Memory of:* Dan Bubalo  
Barb Bucar  
Buffalo House / Scott Stoyanoff  
Darrill & Rita Erickson  
Irving Community Association

Clyde & Julie Johnson  
Elaine Killen  
Violet Leticia  
Dale Lewis  
M. E. Elecmetal  
North Shore Bank  
*In Memory of:* Joe Petrovich

## Commonwealth Avenue Society

*Donations From \$2,500 to \$4,999*

Mark & Linda Boben  
*In Memory of:* Jack E. Johnson  
Steve & Marcia Johnson  
St. Louis County Attorney's Office



## 1914 Associates

Donations From \$5,000 to \$9,999

Gary & Kathleen Bubalo  
Darrel D. Johnson Excavating  
Jeff & Jill Widness

## Founders Society

Donations From \$10,000 to \$24,999

George & Elizabeth Goldfarb Family Foundation  
Al & Erika Hodnik  
Lakehead Constructors Inc.

maurices  
Cheryl & Joe Meese

“My husband and I have lived in Gary-New Duluth for approximately 13 years. We have always felt very comfortable here. On one of my many walks in the neighborhood, I noticed the electronic billboard advertising some senior workout programs. OK, why not stop in, and check it out? From the moment I walked in and introduced

myself, I was greeted not only by the instructor, but also by everyone participating in the class. ***I have never felt so welcomed into any group as I did at the GND REC center.*** Many of these ladies have become true friends. Workouts are not something I dread going to; I actually look forward to my classes. Truly a win-win situation for me!”

—Kathy Pedersen

## Many thanks

Our community partners provided major support to GND REC in 2022. These pictures celebrate that support.



Maurices



Lakehead



North Shore Bank



ME Global, Inc.

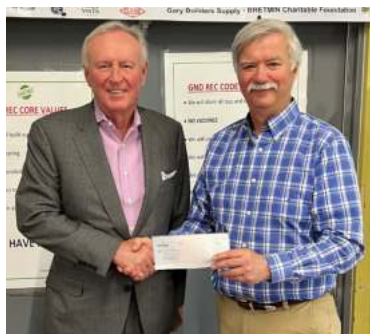

Bell Bank

# Lifetime Contributions *Through December 31, 2022*

## Friends *Donations under \$100*

Anonymous  
Anonymous  
Joe & Shirley Balach  
Steve & Marlene Balach  
Therese Balach  
Mindi Baski  
Doug & Cheryl Belanger  
John & Alice Berg  
Donna Bergstrom  
Donna Bewley  
Joe Blum  
Kelly & David Bolgrien  
James & Laura Booth  
Kyle Boyat  
Jon Brostowitz  
*In Memory of:* Burger Family  
Florence Burger  
Terry Burger  
*In Memory of:* Janet Elizabeth Calhoun  
Mike Sr. & Aurine Casey  
Michael Cheetham  
Al Chepelnik  
Penny & Michael Cragin  
Maranda DeSanto  
Cole DiMeglio  
Sandy Dinehart  
Chuck & Cheri Duval  
Duluth Women's Club  
Brent Elling  
Sharon & Charles Fedora  
Anna Foster  
Dave Geary & Deanne Roquet  
*In Memory of:* Mary Giacominni  
Karen Griffith  
Jake Grondahl  
Mark & Jill Hakala

William & Cheryl Hallamek  
Martha Han  
Richard Haney  
Tom & Marsha Hystad  
Brenda Jacobs  
Jimmy's Kitchen & Bar  
Sean Jones  
Allen Johnson  
Nicola Jurich  
Jackson Karren  
Janet Kennedy  
Kristen Kimsey  
Carroll Koliboski  
Jeanne C. Koneczny  
Josh Kosanovich  
Geraldine Kozloski  
*In Memory of:* Gina Kozul  
Pamela Kramer  
Timothy Larson  
Linda & Arthur Lezama  
Jaki Majeski  
Patricia Mazur  
Brian & Karen McCormick  
Peter & Helen McDonnell  
Kathleen McKeever  
Ann Marie Menart  
Anna Montgomery  
Carole Newkumet  
North Point Realty LLC  
Sam Odden  
Jon & Gail Ohman  
*In Honor of:* Paulette Ozzello  
Parna: Life Source Healing  
Robert Paul  
Kayla Petrich  
*In Memory of:* Theresa Petrich  
Roberta & Wayne Prince  
Mark Privratsky

Sherri Puckett  
Donna Puhl  
Cliff & Nancy Regan  
Joanne Regan  
*In Honor of:* Rendulich Family  
Tom & Kim Rendulich  
Anna Rozova  
*In Memory of:* Sheila Samarzia  
*In Memory of:* Georgeann Sams  
John Schneider  
Melody Schneider  
*In Memory of:* Ron Seguin  
Charles & Barbara Seipp  
Diane Skomars  
Brenda Skorich  
Slovenian Union of America  
Trevor J. Smith  
Glen & Mary Jane Sorenson  
Vera Stephenson  
*In Memory of:* John Stojevich  
*In Memory of:* John Stojevich & sons;  
Tony, John Jr. & Bobby  
*In Memory of:* Stoyanoff Family  
Mary Beth Strand  
Barbara Suliin  
John Susnik  
Terese Tomanek  
Bob & Jean Vanderport  
Lisa Van Doren  
John & Edna Weber  
Pat Whalen  
Mary White  
Evelyn Wietman  
Claudia Wilson  
Mandi Wojciehowski  
Cami Wolk  
Robert Verzich

## Blue/White Club *Donations From \$100 to \$499*

Richard & Yvonne Anderson  
Andren Paint Company / Pete Olson  
Anonymous  
*In Memory of:* Santo J. Antonutti  
*In Honor of:* Joanie Balach  
Lana Joy Balach  
Robert Balach  
Steve Balach Jr.  
*In Honor of:* Steve Balach Jr.  
Mary & Dwight Barth  
Tanya Beckwirth  
Kevin & Kathy Behm  
Yvonne Rizzi-Belich  
Tom Bell  
Brad Bennett  
Clark & Patricia Bennett  
Douglas & Beverly Bennett  
James Bennett  
Donna Benson  
*In Memory of:* Ron Benson  
Kathleen Bergen  
Thomas Bergum  
Craig Binsfield  
David & Jill Blazevec Family  
Diane Bloomquist  
*In Honor of:* Linda Boben

*In Honor of:* Mark & Linda Boben  
Pamela Boben  
*In Memory of:* Stanley & Ruth Boben  
Kelly & David Bolgrien  
Rebecca Bosanko  
Patrice Bradley  
*In Memory of:* Bob Brophy  
Dorothy Bubacz  
*In Memory of:* Dorothy Bubacz  
Leslie & Frank Bucar  
*In Memory of:* Buddy  
Ken Buehler  
James Caesar  
John & Tracy Carey  
Mike Jr. & Laurie Casey  
River Place Campground  
Max Caven Photography  
Charities Aid Foundation America  
*In Honor of:* Children of Our Community  
Alison Clarke  
Eugene Collard  
Lee Conradi  
Kermit & Marilyn Cook  
*In Memory of:* Bill Damkroeger  
Cheryl Danielson  
Mark Danielson  
Nancy & Alexander Darbut  
Marlene David  
Al & Susie Decker  
Douglas Delaney

Brenda S. Denton / Denton Law Office  
Michael & Tanya Dmowski  
Duluth Brass Manufacturing  
Ruth Ann Eaton  
*In Memory of:* Dr. Mark Eckman  
Gary & Kathleen Eisenach  
Maxwell Elfelt  
David Emery  
Melissa Engbretson  
Patricia Erickson  
Suzy Fairchild  
Brenda Fife  
Mike Fife  
Kelly Finnegan  
*In Honor of:* Barbara & Dick Fischer  
*In Memory of:* Joseph Floreano  
Fond du Lac Community Club  
John & Julie Foucault  
Tyrone & Sharon Frost  
Agnes Gallenberg  
Gartner Refrigeration Company  
Elizabeth M. George & Dale D. Sola Charitable Trust  
Eric Gibson  
Dan & Sue Gigliotti  
*In Memory of:* Tom Gillen  
Robert & Karen Glowacki  
Regis Glumac  
GND Cub Scouts Pack 3013



## Blue/White Club (cont.)

### Donations From \$100 to \$499

Andrew & Molly Goldfine  
Beverly Goldfine  
*In Memory of:* Beverly Goldfine  
*In Memory of:* John Mestnick Grassinger  
Wilhelm & Jennifer Grau  
William & Barbara Gravelle  
*In Memory of:* Steve (Stojan) Griak  
Lorrie Griffin  
Donald Gustafson  
Edwin & Sherry Hall  
Timothy Hamman  
Carmen Hartley  
Roger Hartley  
Michael & Liz Henderson  
Charles & Beatrice Herman  
*In Memory of:* Charlie Herman  
Bonnie Hirsch  
Joan & Justin Hoffmann  
*In Memory of:* Richard Hoffman  
Karlie Howard / Computer World Technology  
Husky Energy  
Larry & Jeanne Ivanovich  
*In Memory of:* Joe Janchar  
Joe & Alice Janchar  
*In Memory of:* Agnes Jones  
Dale M. Johnson  
Ken & Norma Johnson  
*In Memory of:* Larry Johnson  
Roxanne Kaldor  
Rosemary Kosevich  
*In Memory of:* Ernie & Martha Laine  
*In Memory of:* Jimmy Lane  
*In Honor of:* Eileen Langlee  
Jon & Patty Langlee  
Michelle Lebeau  
Steve Letica Family  
Ann Lewis  
Brian & Sue Liberty  
*In Memory of:* Bob Marnich

Dan & Jeanne Marnich  
Darrell Martin  
Renee Mattson  
Bill & Gay Vaughn McEwen  
David McLean  
Kevin & Shirley McConnell  
*In Memory of:* Mark Medved  
*In Memory of:* Sharon Medved  
James Menart  
Patty Mester  
Lizette Miller  
*In Memory of:* Patricia M. Modeen  
Paul & Patricia Modeen  
Kim & Mike Monson  
*In Honor of:* Jim Morris  
Scott Morris  
*In Memory of:* Frank & Betty Mrak  
Nassim Family  
Florence Nasti  
Chris & Judy Nelson  
Gilbert (Pete) & Janice Nelson  
Richard Nordberg  
Robert Nordberg  
Alice Nordin  
Millicent O'Connell  
Beth Olson  
Thomas & Carol Ornell  
Jo-Ann Pasek  
Marilynn Pavlich  
Michael & Mary Pavlovich  
Kelly Pelto  
*In Honor of:* Mary Petrich  
*In Memory of:* Thanie Petrich  
Jerry Pfeffer  
Denny & Pat Picconatto  
Weegie Poston  
Amy Rahja  
Joy Rasmussen  
Jack Rendulich  
Dick & Nancy Richie  
*In Honor of:* Helen Rizzi  
*In Memory of:* Ray D. Rizzi  
Henry & Terry Roberts  
John & Barbara Rodberg

Michael Rosa  
*In Memory of:* Sophia & Anton Rubin (Rubcic)  
*In Memory of:* Ray Rybos Sr.  
*In Memory of:* Ray Rybos Sr. & Ray Rybos Jr.  
Susan & Raymond Rybos  
Terry Sanders  
Ryan & Jackie Sather  
Elizabeth Sawyer  
Terri Seiler  
Shamrock Trucking LLC  
Cliff & Barb Sherer  
Joe Siglar  
Joe & Ryann Signorelli  
Mark & Sandra Signorelli  
Jerry & Carol Smith  
Terri Smith  
*In Memory of:* Vince Spallaci  
Amanda Soberg  
Donald Solwold  
Spirit Lake Development / Charlie Stauduhar  
*In Memory of:* Nick Srdar (Nadine Srdar)  
St. George Orthodox Church  
John & Jeanie Stark  
Peter & Darlene Staudohar  
Mark & Patti Stenhammer  
David Stojevich  
Helen Stojevich  
*In Honor of:* Helen Stojevich  
*In Memory of:* Joe Stojevich  
John & Pauline Stojevich  
Patricia Stojevich  
Janice Swanson  
Deb Dwyer / Tutoring Duluth  
Lori Ulvi  
Raymond & Sonja Ulvi  
Steven & Vicki Veit  
Kevin Walli  
Western Area Business & Civic Club  
Whole Foods CO-OP  
Lawrence Wietman Jr.  
Young & Associates Agency Inc.  
Geigerj L. Yount  
Sam & Beverly Zikovich  
Elliot Zunich

## Principal's Club

### Donations From \$500 to \$999

Les & Rosie Adolphson  
Adolphson Real Estate  
Janet Akervik  
Anonymous  
Anonymous  
David Arvold  
Joanie Balach  
Robert Berg  
Lyle & Lynn Bergal  
Allen Boben  
*In Memory of:* Pamela Boben  
Robert & Faith Bubalo  
Laura Budd  
Tracy & Kay Burger  
Jerry & Beverly Cran  
Darlyn J. Davis  
*In Memory of:* Renee Doble  
Dougherty Funeral Home  
Dick Dragovich  
Dolores (Dolly) Dutmer  
Robert & Linda Espenson

Greg & Sheila Fox  
Richard F. Gillen  
Bill Glowacki  
Joyce Goldberg  
Walt & Kay Gower  
*In Memory of:* Hugo & Pearl Hansen Family  
*In Memory of:* Charlie Herman  
Michele & Robert Howard  
Debbie Inwood  
Dale & Paul Johnson's Iron Mug  
Coffee & Ale House  
Peter & Tracey Kolar  
Kraus-Anderson Construction Company  
John Lawien  
Joe & Holly Macor  
Marine Iron & Ship Building Company  
Gordon R. Marinkovich  
Larry & Maureen McGough  
Frank & Deb Messina  
John & Patty Miller  
Morgan Park Community Club  
Northern Orthotic & Prosthetic Center  
Ted & Rae Ann Pavlovich  
*In Memory of:* Rachele Peterson

Mary Petrich  
Puglisi Gun Emporium  
Yvonne Puhl  
Jim & Heath Ransom  
Riverfront Community Fund  
Rotary Club – Harbortown  
*In Honor of:* Neale & Pam Roth  
Mark & Nancy Rubin  
*In Memory of:* Bruno Seppi  
Lawrence Sever Family  
Shots Bar / Kathleen Rose  
*In Memory of:* Susan Skull  
South Pier Inn  
Louie & Pat St. George  
St. Louis County Historical Society  
Richard Turchi  
Karen Turnboom  
Mike & Kathy Tusken  
*In Memory of:* Raymond Ulvi  
Steve & Nancy Waters  
Theodore & Beverly Wenum  
Western Bank

# Lifetime Contributions *Continued* Through December 31, 2022

## Community Pillars

### Donations From \$1,000 to \$2,499

Helene K. Abbott  
Nick Alworth  
Anonymous  
Arrowhead Regional Arts Council  
George Balach  
Bell Bank  
Deanna Bennett Real Estate Team  
*In Memory of:* Edward & Helen Boben  
*In Memory of:* John & Frances Boben  
*In Memory of:* Norman Bourestom  
Judge David & Gloria Bouschor  
Mary Ann Boyat  
*In Memory of:* Robert Boyat  
*In Memory of:* Dan Bubalo  
Barb Bucar  
Frank & Sharon Bucar  
*In Memory of:* Peter Ceskic  
Susan Coen / State Farm Agency  
DAMAGE Boardshop  
Gloria Desmedt  
Bill & Connie Dinan

Darrill & Rita Erickson  
Richard & Barbara Fischer  
Gary-New Duluth Community Club  
Bill & Lynn Gigliotti  
Dave Goldberg Family  
Dave Goldberg / Vintage Acres  
Manufactured Home Community  
Helena Jackson  
Elaine Killen  
Tony & Lois Kochevar  
Korner Store  
KSKJ Life  
A.W. Kuettel & Sons, Inc.  
Marty Larsen  
Robert E. & Jacquelyn Larsen  
*In Memory of:* Leticia Family  
Violet Leticia  
Robert W. & Mary Jo (Balach) Lund  
Robert & Marilyn Maas  
Mars Supply  
Bob & Diane Meierhoff  
Sam Miscevic  
Mont du Lac Resort  
James & Fran Morris  
*In Memory of:* Richard & Claire Nordberg

North Shore Bank  
Mary Olin  
*In Memory of:* Bertha Panyan  
Park State Bank  
Police Service Dogs  
Real Living Messina & Associates  
Rotary Club – Harbortown  
Neale & Pam Roth  
St. Luke's Hospital  
*In Memory of:* Kenneth Schoen  
Jack & Cynthia (Macor) Seiler  
Mitchell & Elva Sill  
John & Barbara Skull  
Mark & Gale Smithson  
John & Judy Smolnikar  
*In Memory of:* David Stoyevich  
Dale & Stefani Summerlin  
Roland Thomas  
Kenneth & Jeanette Turnboom  
Dr. Scott & Dana Varland  
*In Memory of:* John Vekich  
Walmart  
N. Dale Weller  
West Duluth American Legion Post N. 71

## Commonwealth Avenue Society

### Donations From \$2,500 to \$4,999

John T. & Elizabeth T. Adams Art Fund of the  
Duluth Superior Area Community Foundation  
Daniel Lambi Balach  
*In Memory of:* Joe Balach  
*In Memory of:* Steve Balach

Ronald & Margaret Boben  
Ted Bogich  
Buffalo House / Scott Stoyanoff  
Duluth Dog Parks  
Dick Forbort Trojan Legacy  
Ann Glumac & Bill Ulland  
Ted & Carol Griak  
Bill & Kisty Haller  
IKONICS Corporation  
Irving Community Association  
Don Joe

Darrel & Yvette Johnson  
Clyde & Julie Johnson  
*In Memory of:* Jack E. Johnson  
Steve & Marcia Johnson  
Lahti Foundation  
Lake Superior Area REALTOR®, Inc.  
Dale Lewis  
*In Memory of:* Joe Petrovich  
John & Linda Puglisi  
Helen Rizzi

## 1914 Associates

### Donations From \$5,000 to \$9,999

BRETMIN Charitable Foundation  
Debra Cervenka  
Essentia Health Community Giving  
Harold & Ruth Frederick  
The JAMAR Company

Prove Collective  
RBC Wealth Management  
Rotary Club 25 of Duluth  
Kenneth & Concetta Schoen  
U.S. Bank Foundation  
Wells Fargo Foundation

## Founders Society

### Donations From \$10,000 to \$24,999

Anonymous  
Anonymous  
Duluth Legacy Endowment Fund, an affiliate of the  
Duluth Superior Area Community Foundation  
Enbridge Energy  
George & Elizabeth Goldfarb Family Foundation  
Al & Erika Hodnik  
Darrel D. Johnson Excavating

Lakehead Constructors Inc.  
maurices  
Cheryl & Joe Meese  
Kenneth Schoen  
St. Louis County Attorney's Office  
John Vekich  
Vonco V Duluth LLC  
Jeff & Jill Widness

## Harriet Beecher Stowe Society

### Donations From \$25,000 to \$49,999

Arrowhead Youth Soccer Association  
Mark & Linda Boben  
Gary & Kathleen Bubalo  
Community Parks & Recreation Grant  
ConocoPhillips

ME Global  
Minnesota Power Foundation  
Ordean Foundation



---

## Silver

*Donations From \$50,000 to \$99,999*

Northland Foundation  
U.S. Bank Foundation / Minnesota Vikings

---

## Gold

*Donations From \$100,000 to \$249,999*

CN  
DNR STAR Grant & Coastal Grant  
Lloyd K. Johnson Foundation  
Vintage Acres Manufactured Home Community

---

## Diamond

*Donations From \$250,000 to \$999,999*

City of Duluth

---

*Producing an annual list of contributors is always a challenging task with the potential for both human and computer error. The GND Development Alliance has made every effort to list our contributors accurately. If there is an error in your listing, please accept our apologies and email us at: [gnddevelopmentalliance@gmail.com](mailto:gnddevelopmentalliance@gmail.com) so that we may correct our records. **Thank you.***

## BOARD MEMBERS

Mark Boben, Chair  
Barb Bucar, Vice Chair  
Robert Espenson, Secretary  
Ryan Sather, Treasurer  
Gary Bubalo  
Kisty Haller  
Dale Lewis  
Joe Macor  
Frances Morris  
Jack Rendulich  
Chris Skull  
Mike Tusken  
Mary White

### **Joined Board in 2022:**

*Barb Bucar, Mike Tusken  
and Chris Skull*

# Thank you

*to those who provided in-kind contributions of labor, services and materials  
and those businesses, foundations and organizations that provided  
significant monetary contributions*

Advantage Systems Group  
Alta Surveying  
Ames Construction  
Anders Paint  
Arrowhead Youth  
Soccer Association  
ASDCO  
Bell Bank  
Bernick's Beverages & Vending  
Boldt Construction  
BRETMIN Charitable Foundation  
Brock White Construction Materials  
Carpenter's Training Institute  
Century Fence  
City of Duluth  
Clyde Iron  
CN (Canadian National Railroad)  
DADS Electronics  
DAMAGE Boardshop  
Darrel D. Johnson Excavating  
Delzotto Products  
Dinehery Fence & Ironworks  
Duluth Dog Park Organization  
Duluth Fire House #10  
Duluth Public Schools  
Duluth Ready Mix  
Enbridge  
Kim Eskola  
E-Con Placer

Essentia Health  
Gary Builders Supply  
Bill Glowacki  
Goodin Plumbing  
Granite Works  
Great Lakes Stone  
Hailey Sault Marketing  
Hallet Dock  
Halvor Trucking  
Hanco Utilities  
Hartel's Disposal  
HMI  
Ikonics  
International Brotherhood of  
Electrical Workers  
International Union of Painters  
and Allied Trades  
Ironworkers 512  
ISD 709 - Surplus Materials  
Jake's Companies  
JAMAR  
J&B Trucking  
Jeff Foster Trucking  
Johnson Carpet One  
Johnson, Killen & Seiler Attorneys  
Johnson Mertz Appliances  
Johnston Masonry  
Kia of Duluth  
Kivi Bros. Trucking

Krause Anderson Construction  
A. W. Kuettel & Sons  
Lakehead Constructors  
Lakehead Trucking  
Lake Superior Helicopter  
Lake Superior Railroad Museum  
Lloyd K. Johnson Foundation  
London Road Rental  
Mars company  
maurices  
ME Global, Inc.  
Midwest Excavating & Transport  
Miller Creek Lawn and Landscape  
Miller Crew - John Miller, Eric Gibson,  
John Gjelhaug, Joe Kirkeby,  
Jim Leland, Gary Platteter,  
Chris Nelson, Ken Nynas,  
Chuck Seipp, Miles Sternberg,  
John Vekich  
MN Department of  
Natural Resources  
Monarch Paving Company  
Northland Constructors  
North Shore Bank  
Omar's Sand & Gravel  
The Ordean Foundation  
Out There Advertising  
Park State Bank  
Peat Inc.

Real Living / Messina & Associates  
Jack Rendulich Photography  
Rick's Tree & Stump Removal  
Rotary Club  
SAS + Associates  
T. J. Smith  
St. Luke's Hospital  
Stonu Two Harbors  
Stewart-Taylor Printing  
Sunbelt Rental  
Super One  
SWIM Creative  
Thompson Exteriors  
Ulland Brothers  
United Brotherhood of Carpenters  
and Joiners of America  
United Rentals  
US Bank Foundation  
Kevin Vegar Construction  
Veit & Company  
Minnesota Vikings  
Vintage Acres  
Vista Fleet  
VONCO  
Wagner Zaun Architecture  
Walmart  
Walsh Building Products  
Water Heaters Only  
Wizard Works



GND  
DEVELOPMENT  
ALLIANCE



2630 W. Superior St.  
Duluth, MN 55806  
Website: [gnd.community](http://gnd.community)  
Facebook Site:  
[facebook.com/gnd community](https://facebook.com/gndcommunity)

